

# SCP FOUNDATION

Secure. Contain. Protect.

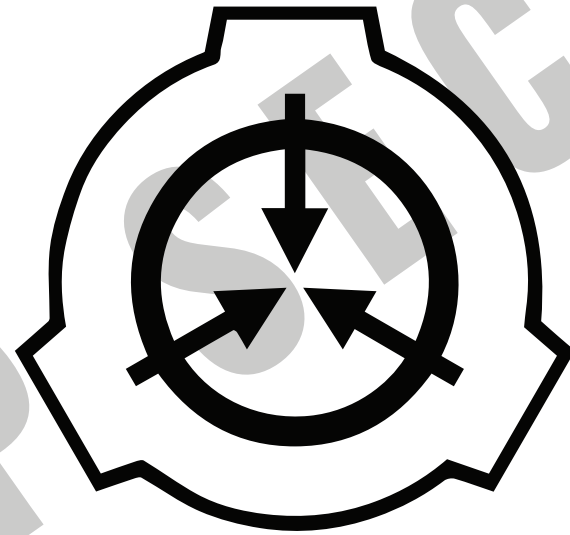

# SITE 19

Haunt Comp 2023

**Stunt**

Group 8

**FOR USE BY FOUNDATION MEMBERS ONLY**



# The Guest Experience

Guests exit the elevator and proceed down a corridor. A scientist emerges from a door, begging for help. **The scientist then suddenly flies upwards, presumably pulled into a portal by SCP-106.**

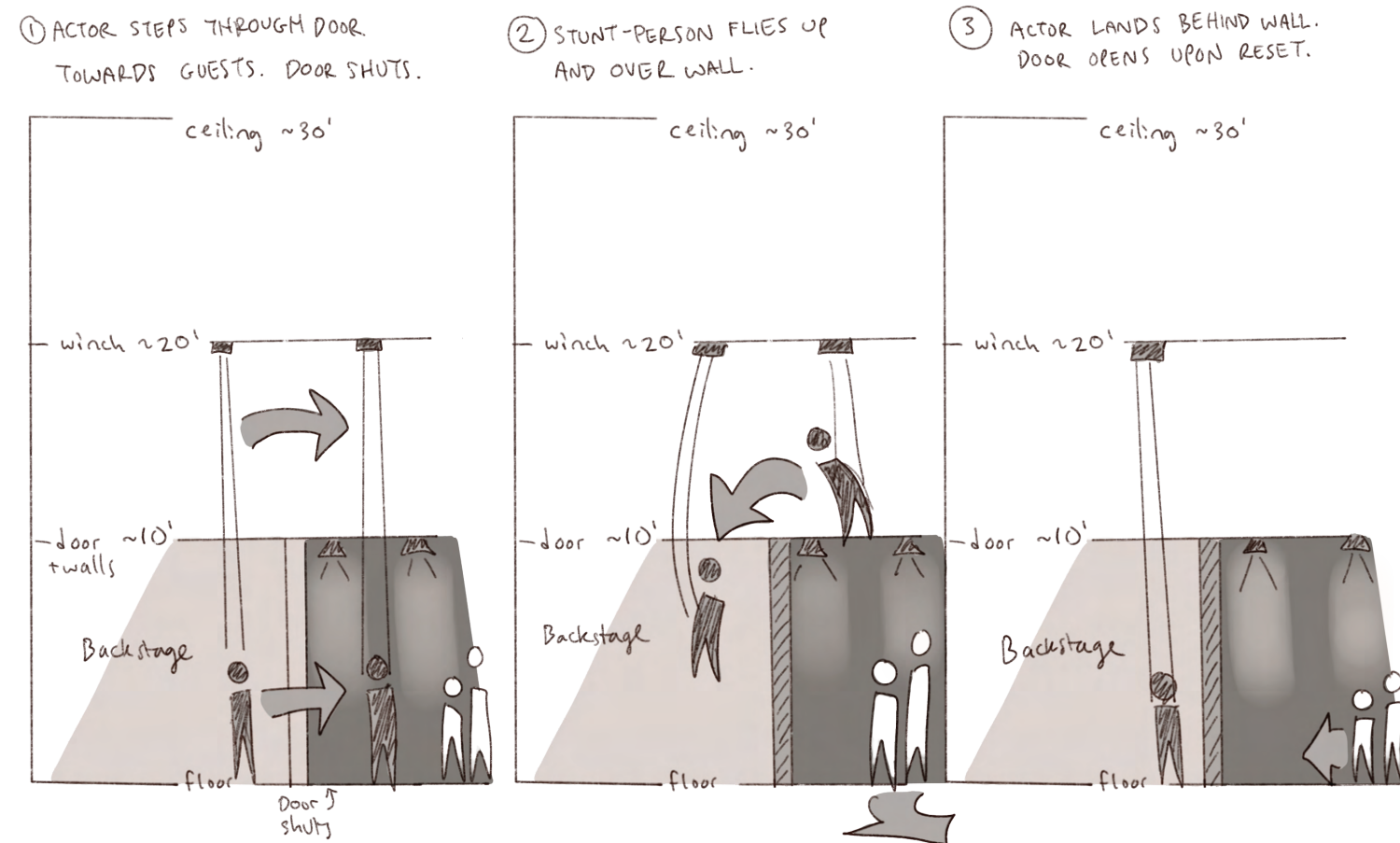

# The Process

Our process involves two actors performing the stunt in rotation. There will be two winches on parallel I-Beam tracks on the ceiling. First, the actor (playing an SCP Scientist) will exit through the door. The door, on a spring mechanism, will close automatically behind them. The scientist, begging for help, will fly upwards into darkness. The winch will then move back on the I-Beam and begin lowering the actor back into the backstage area to reset. As the first actor is being lowered, the other actor will prepare to perform the stunt, utilizing the second winch. The actors will continue this rotation throughout the evening.

# Timeline

Second 0	Second 2	Second 5	Second 10	Second 14
Scientist emerges from the door.	Scientist begs guests for help; door shuts.	Scientist flies upwards.	Scientist is lowered behind the door.	Door opens; stunt is reset for other actor.



## System and Safety

**System:** 3 Foy DW-V3

**Weight Limit:** 200lbs

**Speed:** 20 feet-per-second

**Backup System:** 3rd winch available for actor switch-outs.

The system is designed to have an actor perform the stunt 10-20 times, then take a break.

**Safety Features:** Cushioned landing area, 2 technicians stationed backstage

**Operational Precautions:**

Both technicians must check carabiners prior to anyone flying. Actors may not perform the stunt more than 20 times before a break.

## B-Mode

In the event the stunt cannot be performed safely, a similar effect can be achieved by having an actor lean out of a crack in the door, begging for help from the guests, then acting as if they are being pulled back through the door by a creature, slamming the door as they are pulled.

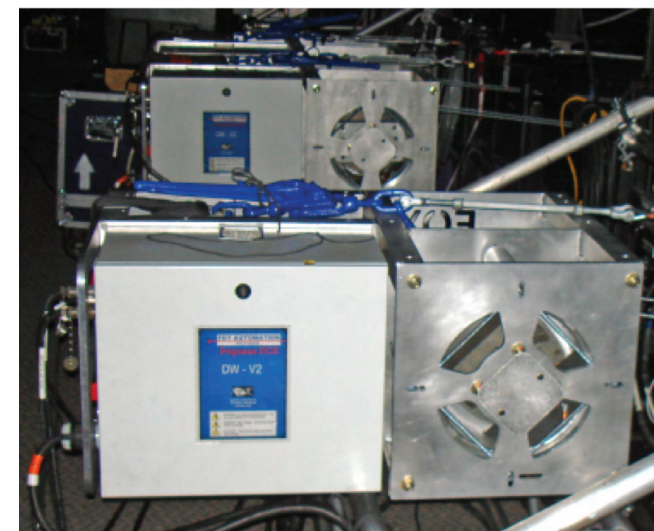

Foy DW-V3

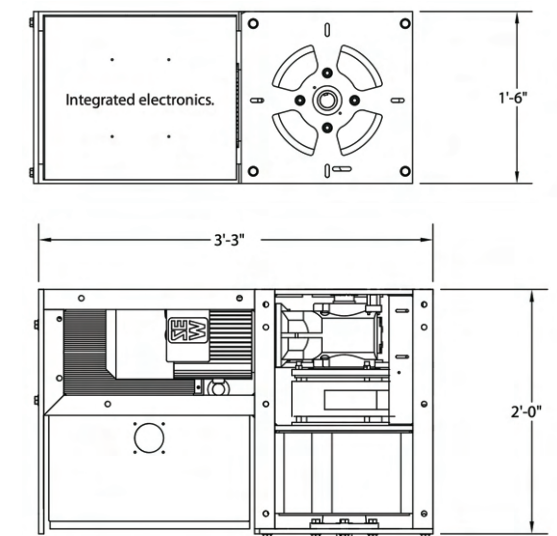

**Top:** Foy DW-V3 Elevation  
**Bottom:** Foy DW-V3 Section

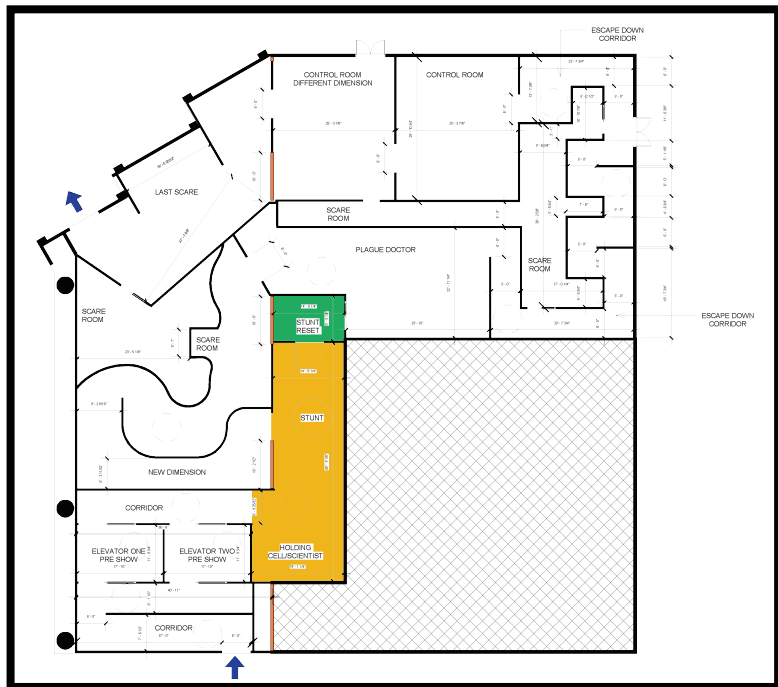

**Location of Stunt in maze.**  
**Green:** Stunt Reset Room.  
**Yellow:** Stunt Zone.

**Right:** SketchUp model of winch system for stunt.  
**Far Right:** Rendering of guest experience during stunt.

